

LET'S LEARN STEP UP AND SPEAK OUT!

Module 7 – Pick your own issue

What's the issue?



We hope that one day, our children will be changemakers, with faith as their foundation.

Children recognize that there are injustices in the world. Let them bring up problems that they have observed and choose one to work on. Help them map their “heartbreak cause” using the suggested steps here:

<https://www.learningtogive.org/resources/map-your-heartbreak-change-world>

What do we already know?

Brainstorm together to find out what the group already knows about the issue. Is their knowledge fact or anecdote?

Does your group want to learn more? Visit a nonprofit which already works on the issue to learn about their work.

Coach the members on using respectful language and generous listening to honor all contributions to the conversation and to be curious about others' ideas.

Facts and Words to Know

Research the chosen problem on the Internet or at the library. Statistics can help galvanize a group to action when they understand the extent of the problem.

For example, if they are concerned about plastic use, learning how much plastic flatware or straws are thrown away every day may prompt them to a campaign to carry one's own silverware or straw.

There may be new words to learn and old words that should no longer be used. Make a list of them.

This is an important time to discuss how to research facts that are impartial and to learn how to analyze data.

Experience the challenges of this issue:

Experiential learning helps to develop empathy. How can the group replicate the issue at hand in a safe environment in order to develop experiential empathy?

For example, continuing the theme in the above section: How many is 1000 straws? Can plastic flatware be broken down or reused? Is it very difficult to carry one's own utensils on a regular basis?

What's next?

You can Dig Deeper or Lighten it Up!

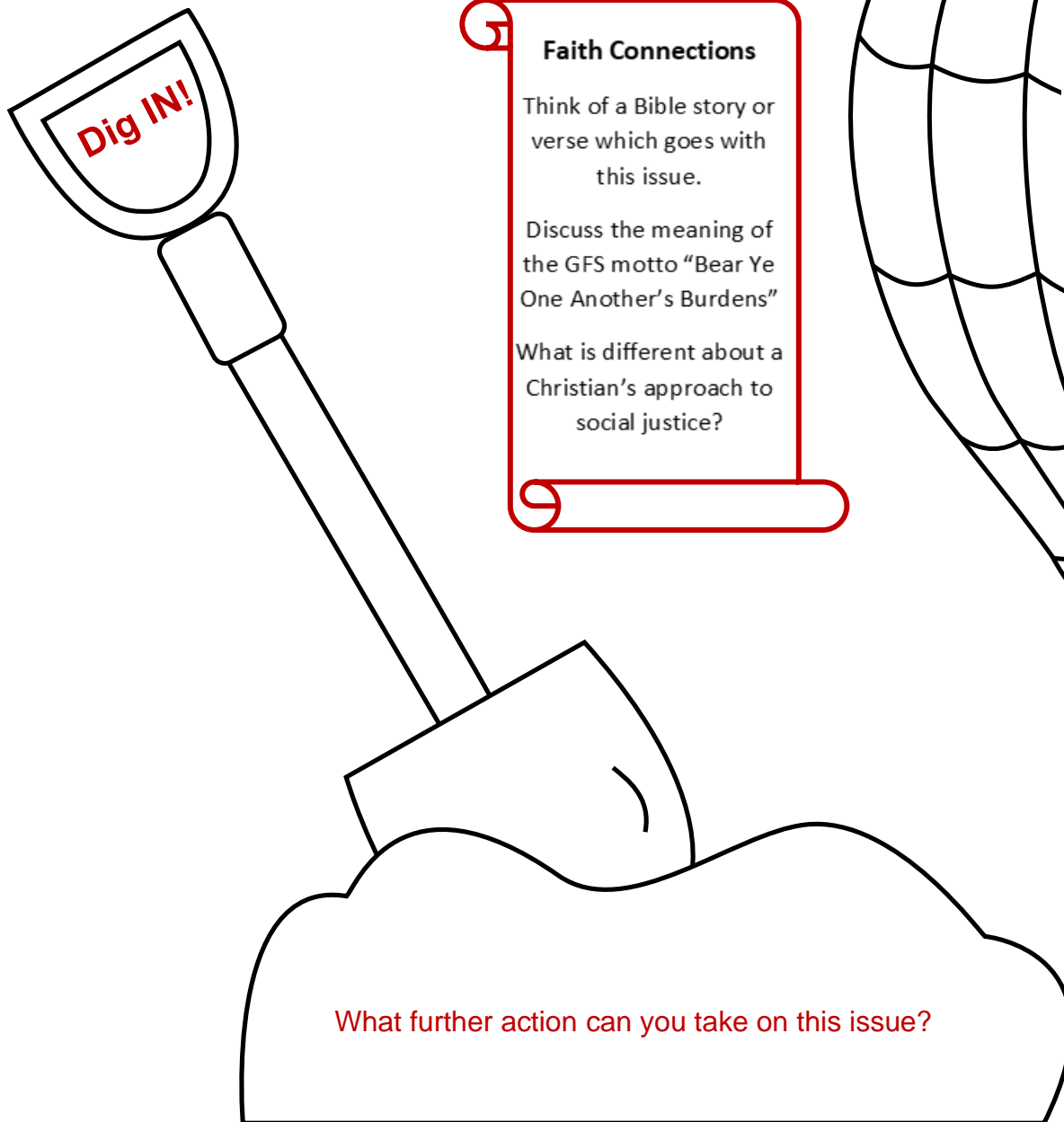

G **Faith Connections**

Think of a Bible story or verse which goes with this issue.

Discuss the meaning of the GFS motto "Bear Ye One Another's Burdens"

What is different about a Christian's approach to social justice?

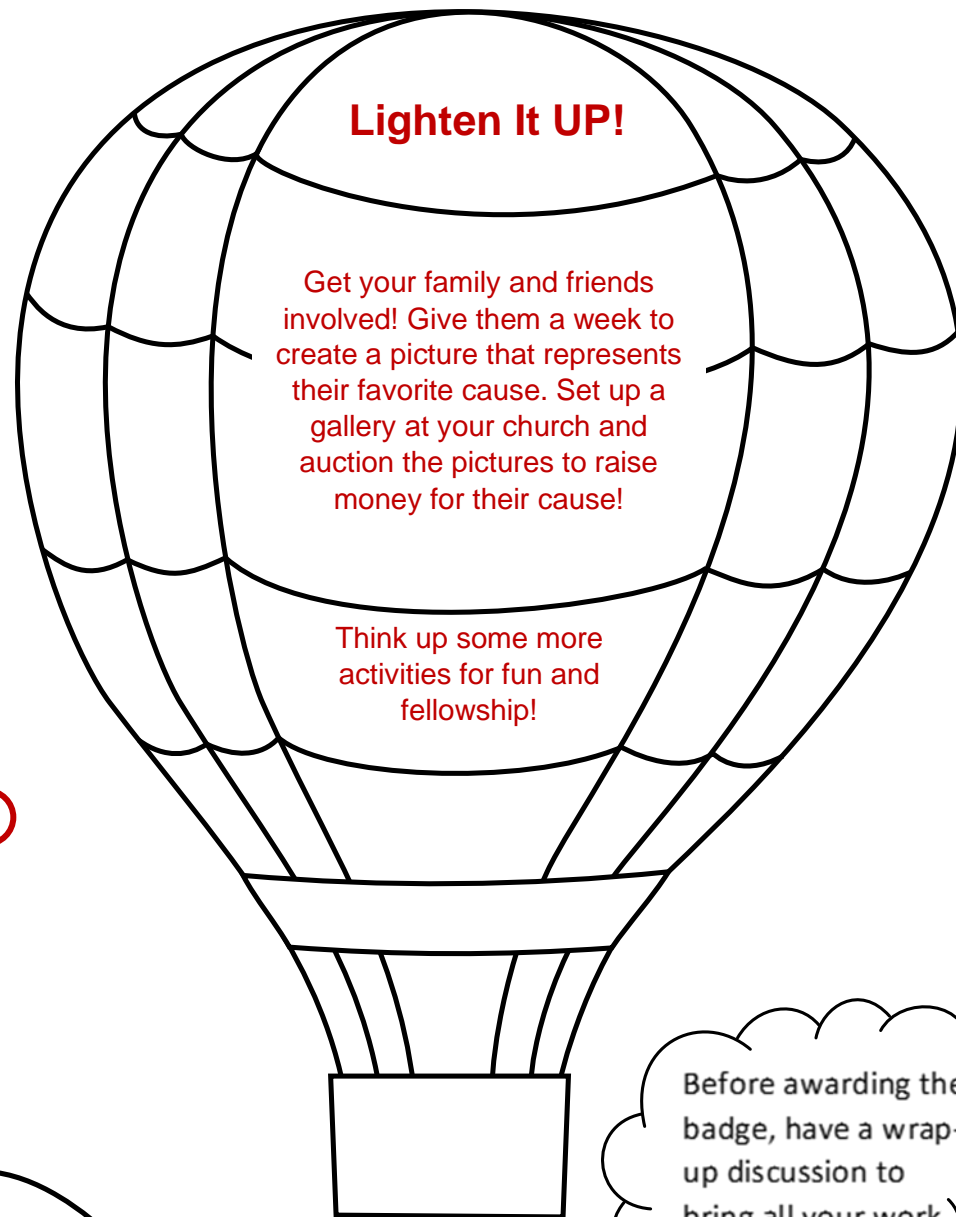

A program provided by GFS in the Diocese of Los Angeles (2021)